

# MAX 7341

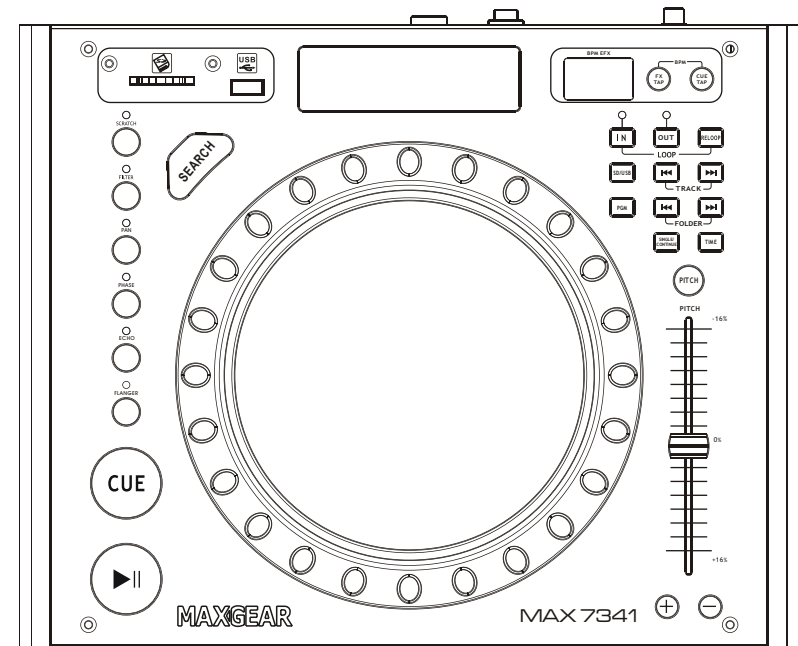

## USER`S MANUAL



**CAUTION:**

TO REDUCE THE RISK OF ELECTRIC SHOCK DO NOT REMOVE THE COVER (OR BACK) THERE ARE NO SERVICEABLE PARTS INSIDE.REFER SERVICING TO QUALIFIED SERVICE PERSONNEL.

The lighting flash with arrowhead symbol,within an equilateral triangle,is intended to alert the user to the presence of un insulated "dangerous voltage"within the products enclosure that may be of sufficient magnitude to constitute a risk of electric shock to persons.

The exclamation point within an equilateral triangle is intended to alert the user to the presence of important operating and maintenance(servicing) instructions in the literature accompanying the appliance.

**WARNING:**

To reduce the risk of fire or electrical shock, do not expose this appliance to rain or moisture. Electrical equipment should NEVER be kept or stored in damp environments. The products do not Compatible with HCSD card and Mp3 display stick.

**DANGER:**

Invisible laser radiation when open and interlock failed or defeated.avoid direct exposure to beam.

**CAUTION:**

This product utilizes a laser.use of controls or adjustments other than those Specified herein may result in hazardous radiation exposure.

**IMPORTANT**

Use of controls or adjustments or performance of procedures other than those specified herein may result in hazardous radiation exposure.

**USER MANUAL**

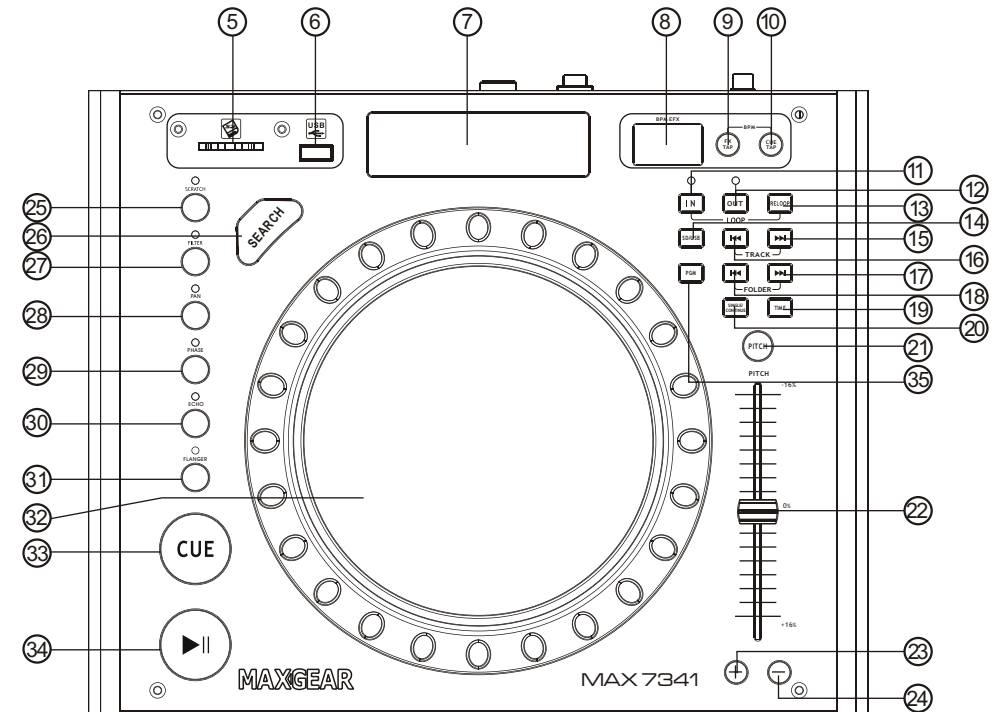
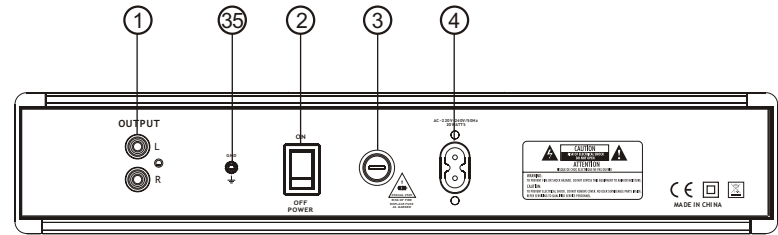

### 1. STEREO MAIN OUTPUT

Unbalanced RCA connectors controlled by the master fader.

### 2. POWER SWITCH

Press the power switch to turn the unit on. To switch the POWER off press the POWER switch again.

### 3. FUSES

Under normal operation the fuses should not blow. A blown fuse usually indicates an overload or fault condition. To change the fuse, remove the power cord, pry off the fuse block with a small flathead screwdriver and change the blown fuses. Refer to the specification for fuse current ratings.

### 4. AC CORD

Used this cable to connect the AC mains power to the unit

### 5. SD PORT

Insert the SD card.

### 6. USB PORT

Insert the USB.

### 7. DISPLAY

### B. TIME MODE INDICATORS

ELAPSED: Played time of the selected track.  
TOTAL REMAINING: Total remaining play time of the SD CARD or USB.  
REMAINING: Remaining play time of the selected track.

### C. "PROGRAM" INDICATOR

This indicates the player is in programme mode.

### D. REPEAT INDICATOR

REPEAT 1: The SD CARD or USB player is playing the selected track repeatedly.  
REPEAT ALL: The SD CARD or USB player is playing the entire SD CARD or USB repeatedly.

### E. TIME BAR INDICATOR

This is a graphical representation of the "Minute, second and frame displays" (C).

### F. "PITCH" INDICATOR

This indicates the pitch slider (12) is activated.

### G. "LOOP" INDICATOR

This indicates the SD CARD or USB player is currently playing in a preset loop.

### H. PITCH DISPLAY

This indicates the playback speed (pitch), from 16% to +16%.

### I. PLAY MODE INDICATORS

SINGLE: The SD CARD or USB player is in single mode.  
CONTINUE: The SD CARD or USB player is in continue mode.  
ROBO: The SD CARD or USB player is in relay mode.

### J. MINUTE, SECOND AND FRAME DISPLAYS

These displays shows the current time, the value changes depends on the time mode selected.

### K. "CUE" INDICATOR

This indicates a new cue is set.

### L. TRACK NUMBER

This displays the position, number of track of the SD CARD or USB, which is playing.

### M. FOLDER DISPLAY

### N. ID3 COMMUNICATION DISPLAY

### 8. BPM EFX

### 9. FX TAP BUTTON

### 10. CUE TAP BUTTON

### 11. IN BUTTON ( LOOP SYSTEM )

This button sets the beginning of the loop. The Loop indicator on the display flashes.

### 12. OUT BUTTON ( LOOP BUTTON )

When you press this button, you set the end point of the seamless loop and you start the loop. To finish the loop, press again this button.

### 13. RELOOP BUTTON ( LOOP SYSTEM )

This button is used to start the last saved loop.

### 14. SD/USB BUTTON

- Press the first : control the SD card function.  
- Press the second: control the USB function.  
- Press along time ,after display "P-OFF" and will shut off the power for SD card/USB.  
- If you take away the SD card/USB, then pressing the botton, will start up the SD/USB.

### 15. SKIP>>I BUTTON

In the "TRACK" mode, is next track.

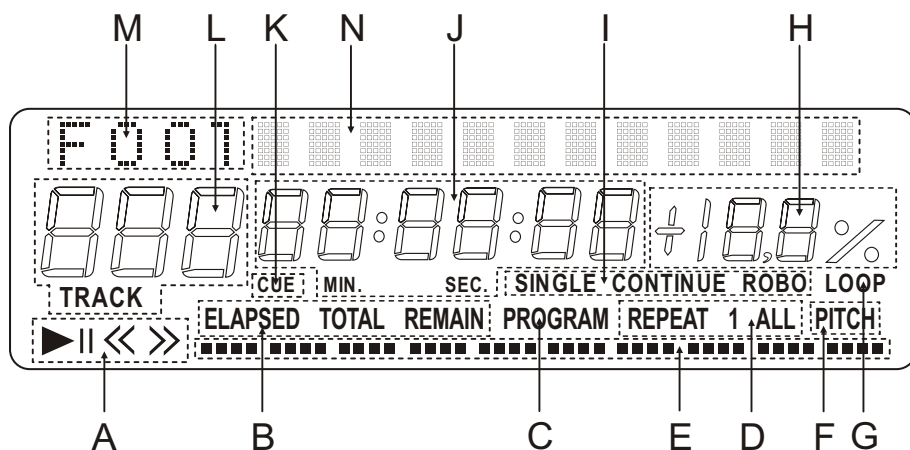

### A. OPERATING MODE

These indicate the operating mode of the SD CARD or USB player

▶ : The SD CARD or USB player is playing the SD CARD or USB.

|| : The playback is paused.

**16. SKIP I<< BUTTON**

In the "TRACK" mode, is last track.

**17. SKIP >>I BUTTON**

In "FOLDER" mode, IS NEXT FOLDER.

**18. SKIP I<< BUTTON**

In the "FOLDER" mode, is last folder.

**19. TIME BUTTON**

Use this knob to choose the time mode: Elapsed time, remaining time or total remaining time.

**20. CONTINUE / SINGLE BUTTON**

Press these to switch between the SINGLE and CONTINUOUS play mode. The selected mode is indicated on the LCD. In SINGLE mode, after each track, the unit stops the reading. In continu mode, the unit read all track and stops.

**21. PITCH BUTTON**

If you push this button ,the adjustment of the pitch potentiometer is available.

**22. PITCH CONTROL**

Use this fader to increase or decrease the speed of the track.

**23. PITCH BEND + BUTTON**

The pitch will automatically rise when the + button is pressed and return to the original pitch when it is released.

**24. PITCH BEND - BUTTON**

The pitch will drop while the - button is pressed and return to the original pitch when it is released.

**25. SCRATCH BUTTON**

When the indicator LED is light, dial the jog for SCRATCH function.

**26. SEARCH BUTTON**

When the indicator LED is light, dial the jog for quick search forward and backward,

**27. FILTER BUTTON**

Use the Filter button -27- to deactivate a band pass filter which permits playing at a certain frequency.

**28. PAN BUTTON**

The Pan button -28- activates a Balance effect. This effect, depending on the beat frequency, alternates the signal from the left to the right loudspeaker side.

**29. PHASE BUTTON**

Use the Phase button -29- to activate the phase effect. Although similar to a flanger, it emphasise the upper pitch less and sounds slightly more harmonious.

**30. ECHO BUTTON**

Use the Echo button -30- to activate a Reverb/Echo effect.

**31. FLANGER BUTTON**

Use the Flanger button -31- to activate the flanger effect. This frequently applied effect is similar to the Phase effect, but slightly more harmonious, emphasises the upper pitch more and is reminiscent of a flying aircraft.

**32. JOG & SHUTTLE WHEELS**

The CD player features an extra large Jog Wheel for a real vinyl-like operation. This is generally divided into two sections for scratch applications. The top section is touch sensitive and responds to the body's own electricity - similar to a vinyl record on the turntable. The outer rubberised ring has been designed for pitch bending - similar to the edge of a turntable's platter. If the Scratch function -25- has been deactivated, the entire Jog Wheel also works as a Search and Pitch Bend wheel. By turning clockwise and counter- clockwise while in Cue and Pause mode, you can precision-frame-search a Cue Point. While in Play mode, use the Jog Wheel, similar to a turntable, for pitch bending (during deactivated Scratch -25-). This is a quick increase (push start) or decrease (stop) of the pitch. The faster the Jog Wheel is turned, the quicker the change of pitch. The same effect can be achieved with the Pitch Bend buttons -23- and Pitch Bend buttons-24-.

**33. CUE BUTTON**

- In pause mode use the search button to search the position you want.  
- Now press play button.  
- Press CUE button will go back to where you start.

**34. PLAY / PAUSE BUTTON**

Each time you press the PLAY/PAUSE button, the operation changes from play to pause or from pause to play.

**35. PGM BUTTON**

In STOP mode, you can program several tracks (20 tracks max.) :  
- Press the PAUSE button to enter in the stop mode  
- Press the PGM button to enter in the program mode  
- Use the skip track buttons to choose the track you want to listen then press the PGM button to enter your choice.  
- Use one more time the skip track buttons to choose the track you want to listen then press the PGM button to enter your choice.  
- Repeat the operation to select all the track you want to listen  
- Press the PLAY / PAUSE button to start the playback

**SPECIFICATIONS :**

Mp3 Decoding.....Support 16/22.05/24/32/44.1/48kHz sampling frequencies and bit rate from 32kbps to 320kbps  
Power Supply .....AC 220-240V~50 Hz  
Dimension.....325x260x82mm

